

SECTION A-A

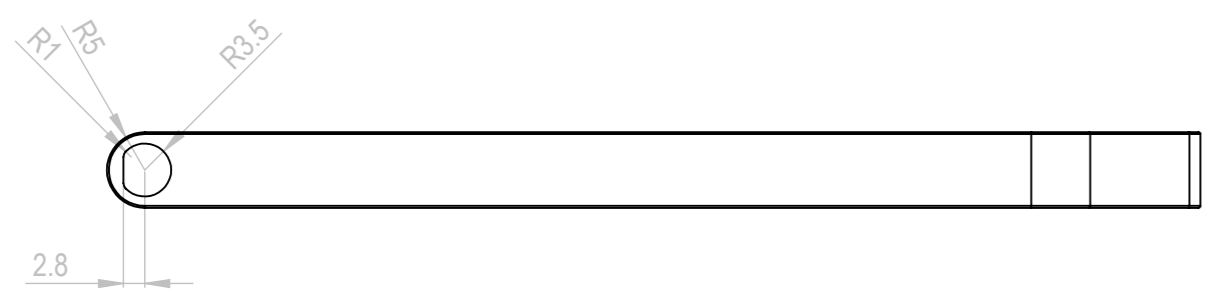
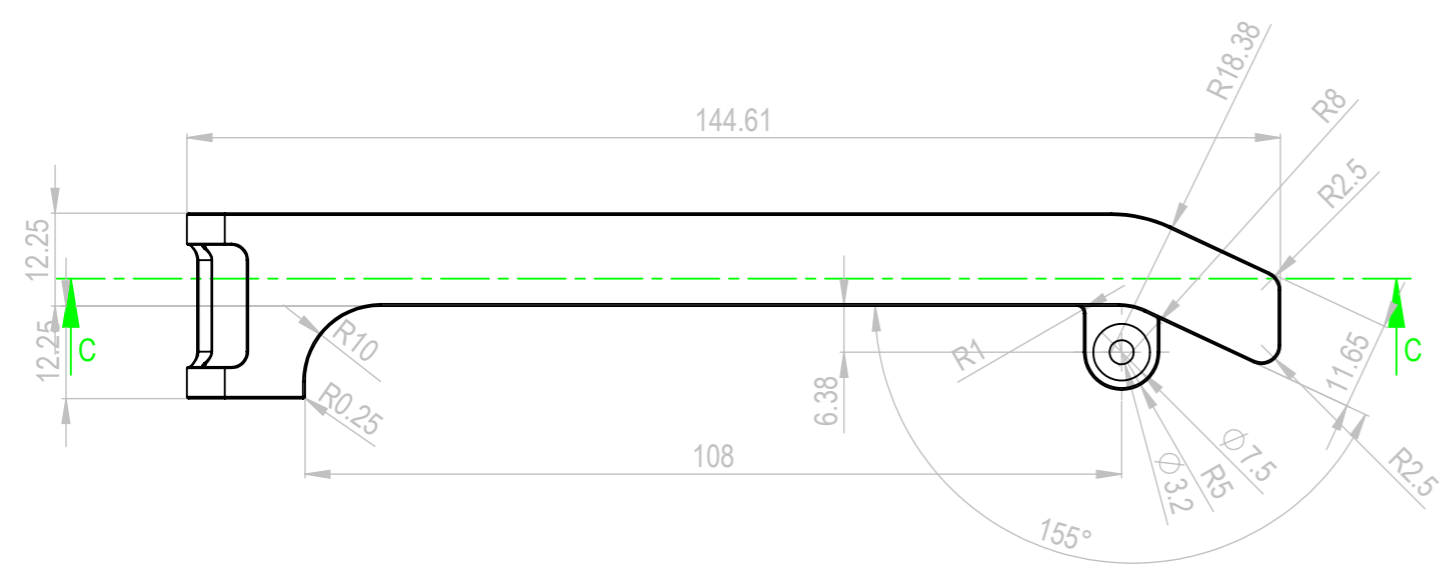
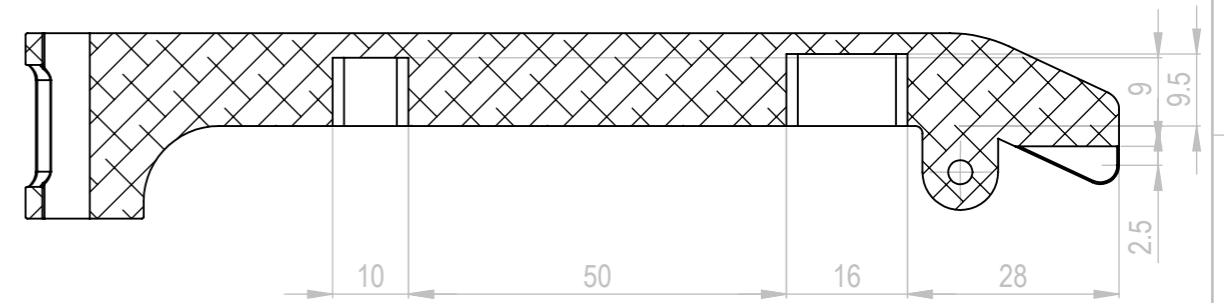

- NOTES:
1. MATERIAL: 6082 ALUMINIUM
145X12X25 PLATE
 2. MATERIAL CERTIFICATION REQUIRED
 3. FINISH: NATURAL ANODISE,
 4. BREAK (0.1~0.2) SHARP EDGES & RADIUS
 5. REMOVE ALL BURRS
 6. FIRST ARTICAL INSPECTION REPORT ON ALL DIMENSIONS
 7. GENERAL OVER CHAMFER 0.25mmX0.25mm
 8. QTY PER UNIT: 1 PER UNIT

<p>CONFIDENTIAL: All rights reserved. Communications or reproduction without written approval from FlightScope (Pty.) Ltd. forbidden.</p>	MATERIAL: 6061-T6 (SS)			TOLERANCE UNLESS OTHERWISE SPECIFIED DIMENSIONS ARE IN MILLIMETERS LINEAR 0 = ±0.5 0.0 = ±0.25 0.00 = ±0.15 0.000 = ±0.015 SURFACE = S/METAL BEND $\leq \pm 0.2^\circ$ MACHINED ANGLE $\leq \pm 0.2^\circ$	DESCRIPTION	FIRST ANGLE PROJ. DO NOT SCALE DRAWING SCALE 1:1 SHEET 1 OF 1 PAPER SIZE A3
	TEXTURE: AS PER DWG FINISH: WEIGHT(g): 47.72				FS Xi FOLD OUT LEG	
OFFICIAL RELEASE	23/08/2013	HB	SB	HB	PRT. NO	E47-5W580-A
DETAIL	DATE	DRW	CH'CK'D	ENG		